



Rooftop View

Living on the Hills

A signature development by PJD Group, Windmill Upon Hills is set to redefine the extravagance of hill living

One of life's greatest pleasures is to dip in a hot spa on elevated grounds enveloped by spring mist. Common on the hills of Canada, South Korea and Japan, it is rare in a tropical country such as Malaysia. It is even rarer when that place is a mere 45 minutes' scenic drive from the city centre. That's what you can experience soon at Windmill Upon Hills, a serviced apartment perched on 5.5 acres on the rolling hill, which is a stone throw away from the integrated resort city of Genting Highlands, set 1,000m above sea level.

The perpetual spring weather and lush greenery are guaranteed to wash away all the stresses of city life, leaving you refreshed and rejuvenated to face the excitement the hills have to offer. And there are plenty, chief among them is the world's first Twentieth Century Fox World Theme Park (to be completed by 2016) and the famed casinos of Genting Highlands.

The location famous to many, has been receiving a lot of renewed interest since the government and Genting Group announced the Genting Integrated Tourism Plan in Dec 2013. According to the press release disseminated by Genting Berhad, it is estimated that over 30 million people will visit Resorts World Genting by 2020 upon completion of all the new world-class attractions which form part of the Genting Integrated Tourism Plan (GITP). Besides a new cable car station, a new hotel will also be built along with the much anticipated theme park. Keen shoppers will be pleased to know that a proposed Premium Outlet will be among the retail components to be added, in addition to the proposed Sky Plaza shopping mall. This new mall is set to become the latest lifestyle mall at the Resort offering retail, food and beverage outlets and entertainment space that include cinemas.

Even prior to this ambitious plan, Genting as a location in the present has a wide array

of amenities that make it a self-sufficient township. Only 45 minutes from Kuala Lumpur City Centre and a mere 30 minutes to Ampang and Gombak, the highland, in particular the mid-hill section around Gohtong Jaya and Genting Permai have been attracting city slickers to pack their bags and move permanently there.

Says GK Lim, 72, a businessman who used to reside in Jalan Ipoh, KL and a current resident in Genting Permai: "It has been six years since I decided to move to Genting and commute to my son's office a few times a week. It's only less than an hour's drive. I moved here because of the clean and non-polluted air, and the cool breeze all year round. The cost of living here is not expensive if you're here for long term. I do



my groceries down in Ulu Yam or Bentong where things are actually cheap and affordable. For entertainment, I'd just take a 15-minute drive up hill where I get to watch a movie or enjoy a good show."

Like Lim, the allure of hill living is not lost on an increasing number of residents from the city. Many are seeking a haven where they can escape the hustle and bustle of city life and enjoy highland weather and cooling fresh air all year round at the edge of KL. Among the several choices available, the one that stands out the most is Windmill Upon Hills which ticks all the right boxes.

Best Vantage Point

Situated at mid-hill in Genting Permai, Windmill Upon Hills occupies arguably the best vantage point along the hillside and is fifteen minutes' drive away from everything – 5 minutes from the cable car station and Gohtong Jaya's eateries and 15 minutes to Resort World's vast entertainment complex at the hilltop. The 42-storey high serviced apartments are also a stone's throw away from the golf course and Highlands International boarding school. Besides being suitable as a permanent home for KL-lites working in the city, the fully-furnished units are also perfect as a holiday home for families across the country and a home for retirees. Research has shown that spending time in fresh air,

to the potential demand as the new Genting development gets underway.

The facilities offered at the development are built to cater to everyone – the Rooftop Sanctuary with its Jacuzzi, pools and Cabanas attract those seeking to chill out while the Rejuvenating Deck which houses a hot spa, jogging tracks, squash and tennis courts plus hammock swings appeal to the more active residents. For those who just want to meditate and enjoy the cool surroundings and chirping birds, the Terraced Garden is where they should head to. The rooftop also houses a beautiful Celebration Alcove which can be utilised for weddings, birthday celebrations and private functions.

Windmill Upon Hills fills the gap for those who long for a high quality development with an extensive list of facilities. To be managed by the renowned Swiss-Garden Hotel, Resorts and Inns, the development is assured of professional maintenance due to its established track record in the hospitality industry, says Ricky Ang, Chief Operating Officer, Swiss-Garden International.

surrounded by nature, increases energy in 90 per cent of people.

A signature development by PJD Group, the 1,108 freehold units come in a variety of configurations – from studio (362 sq ft) to 2-3 bedroom apartments (688 sq ft to 783 sq ft), as well as the dual key and double dual key units that range from 1268sq ft to 1523sq ft that caters to the different needs of small groups to large families. For those who prefer a modern and new concept, a duplex with an expansive 962sq ft will be the perfect selection. Slated to be launched in the 2nd quarter of 2015, the apartments make for a very good investment choice due

"We have been in Hospitality Management for a quarter of a century and has extensive experience and credentials in successfully operating a diversity of products, ranging from city hotels to beach resorts to serviced residences. With an existing stable of 12 hospitality products, Swiss-Garden International has an extensive network of distribution that makes us well-positioned to not just complement but to surely enhance the entire success of investments in Windmill Upon Hills," says Ang.



Podium @ Level 5



Brooks & Bridges

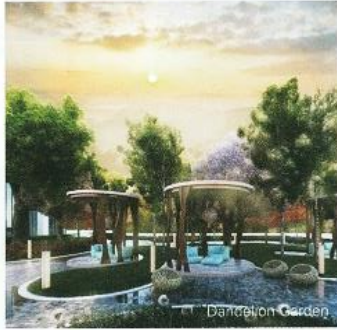

Dan戎Garden

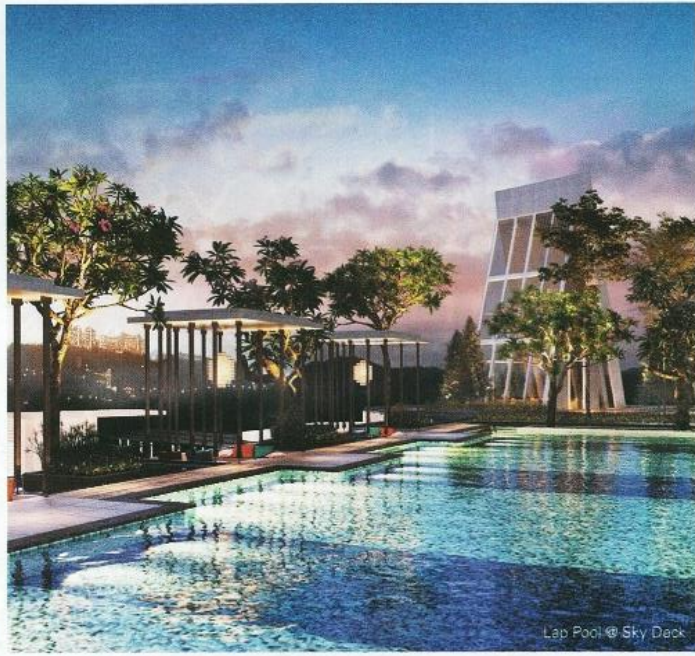

Lap Pool @ Sky Deck



FREEHOLD

He adds that the timing of Windmill Upon Hills is also perfect as it coincides nicely with the obvious accommodation demand stemming from the developments in the area. "We certainly foresee significant volume of holiday makers particularly from family trips that prefer multi-room-residence type accommodations, to flock to the location."

"Nature is fuel for the soul."
Richard Ryan

Wind Concept

The windmill concept is chosen as it represents energy from the everlasting and powerful wind. The development has three wings that has the shape of a windmill. It is designed to maximise the view from every corner of every unit. "It is built in such a way that we want residents to be able to enjoy the best views from wherever they are," says Nicole Lee, General Manager, Sales & Marketing. A lot of thought and precision have also been put into the landscaping surrounding the development so that the significance of panorama is remembered. "We're living in such a fast-paced society and people tend to forget about the importance of spending time outside and underestimate the health benefits of experiencing outdoors in nature," adds Lee.

"At Windmill Upon Hills, people get to enjoy fresh air, the gentle breeze and a cooling atmosphere. This is where we want residents to feel rejuvenated and to renew their energy over a relaxing retreat - ensuring that their wellness is being taken care of alongside our list of facilities provided."

Windmill Upon Hills will be open for an exclusive public preview on 9 & 10 May 2015 at the Genting Permai Sales Gallery. For more information about the development, kindly contact 03-6100 2339

Make your move to the

OFFICIAL PREVIEW

of Windmill Upon Hills

DATE:

9 & 10 MAY
(Saturday & Sunday)

VENUE:

Showcase Gallery
B-P7 & B-P8, Jalan Permai Genting
Permai Avenue, Genting Highlands
69000 Bentong, Pahang

GPS Coordinates:
3°23'10.09"N, 101°48'27.09"E
Waze: Windmill Upon Hills



CALL +603 6100 2339

windmilluponhills@pjdprop.com.my | www.windmilluponhills.com

PJD REALTY SDN BHD (231809-M) (A subsidiary of PJD Group) Level 18, Plaza OSK, Jalan Ampang, 50450 Kuala Lumpur.

Developer: **PJD GROUP**

* Developer's License No.: 11821-2/11-2016/01357(1) - Validity Period: 14/1/2014 - 13/11/2016 - Advertising Permit No.: 11821-2/11-2016/01157(P) - Validity Period: 14/11/2014 - 13/11/2016 - Building Plan Approval No.: 11610/m.A/BRTG/BK3/GH/4/12/2014 - Approving Authority: Majlis Perbandaran Bentong - Land Tenure: FREEHOLD - Expected Date of Completion: May 2019 - Land Encumbrances: Public Bank Berhad - Service Apartments - Total Units: 1108 - Built-up Area: 36284 sq ft - Selling Price RM492,000 (unit) - RM1,085,000 (unit) - Bonus Points Discount: 3%
All pictures and illustrations contained herein are artist's impressions only. All statements and illustrations are subject to change without prior notice as may be required by the developer consultants and / or the relevant authorities. Whilst every care has been taken in providing this information, the developer shall not be held responsible for variations.